

KESSEL - floor drain ME

(F) Siphon de sol KESSEL "floor drain ME"

Nr. 373001

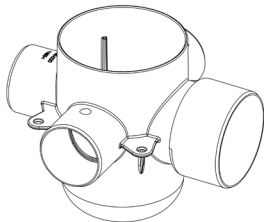

EN 1253-1 / Typ 1 / A

Product advantages

- (GB) - Optional "knock-out" plugs for three pipes
 - Adaptors available for DN 75 and DN 50 pipe sizes
 - comprehensive accessories available
 - 3 lateral $\varnothing 2''$ (55 mm) inlets with 1 lateral $\varnothing 3''$ (82 mm) outlet
 - discharge: 0.9 l per 10 mm accumulation
 - discharge: 1.1 l per 20 mm accumulation
-
- (F) - Ouverture optionnelle de 3 entrées
 - avec des accessoires complémentaire extensible sur DN 75 et 3 x DN 50
 - Accessoires divers
 - 3 adaptateurs d'entrée en $\varnothing 2''$ (55 mm)
 - 1 adaptateur de sortie en $\varnothing 3''$ (82 mm)
 - capacité de drainage: 0.9 l per 10 mm accumulation
 - capacité de drainage: 1.1 l per 20 mm accumulation

2019/05

Order Nr. / Réf : 010-877

 **KESSEL**



Installation and assembly

F Conseils d'installation

1.

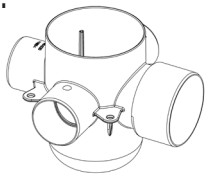

2.

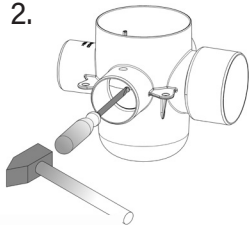

3.

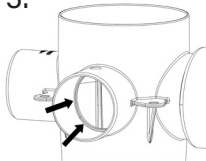

4.

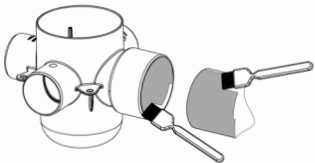

5.

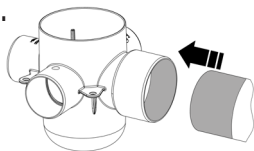

Use only solvent cement/glue for ABS and PVC piping / Utiliser uniquement une colle appropriée pour ABS et PVC.
Follow solvent cement/Glue application instructions / Les indications du fabricant de colle sont à respecter.

6.

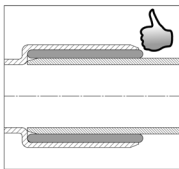

7.

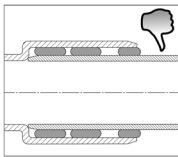

Installation and assembly

F Conseils d'installation

8.

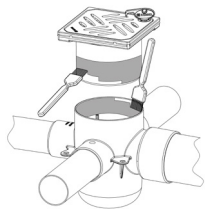

9.

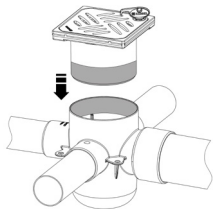

10.

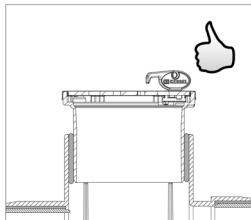

11.

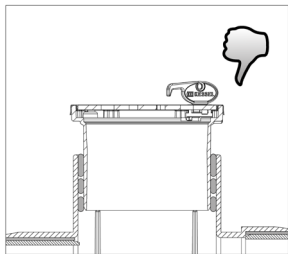

12.

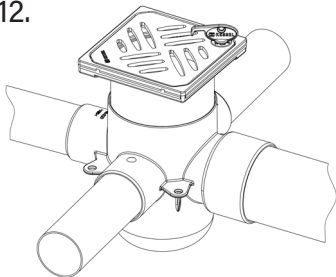

Installation suggestion

F Exemple d'implantation

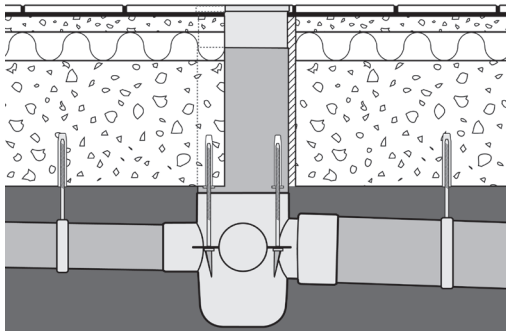
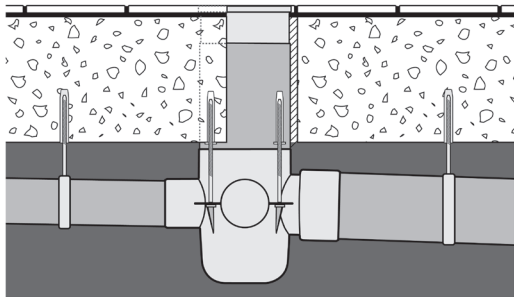

Maintenance

F Maintenance

1.

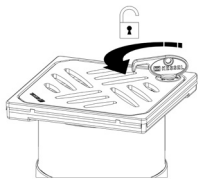

2.

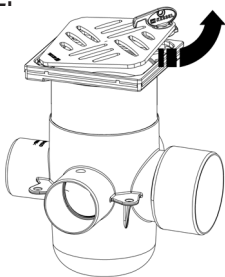

3.

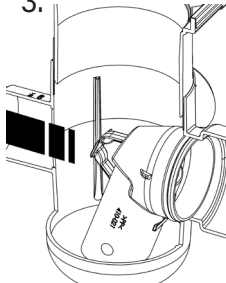

4.

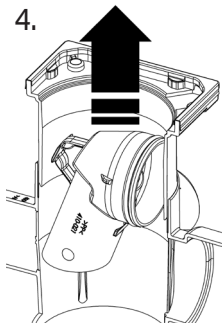

5.

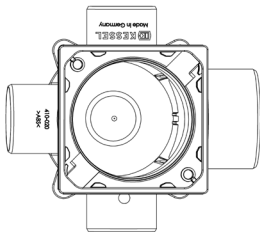

6.

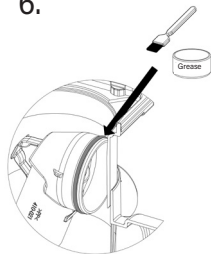

7.

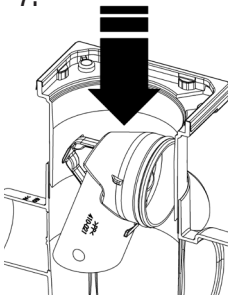

8.

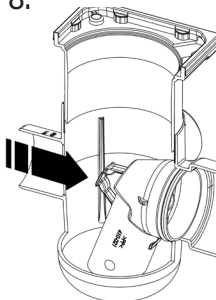

9.

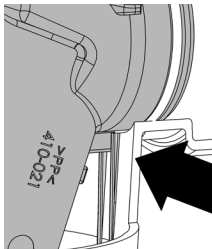

10.

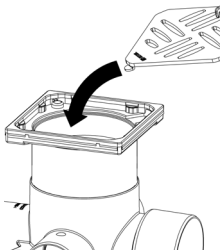

11.

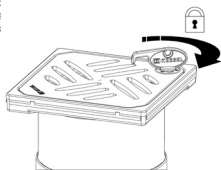

12.

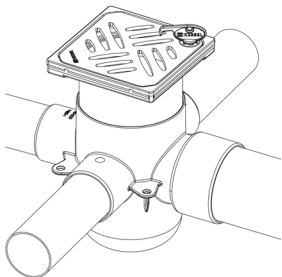

Notes

Notes